

alfakel

TECHNOLOGY FOR SOUNDPROOFING



WOODEN **ACOUSTIC BARRIERS** - **ALFA**

BS-2M-IBOCE



Description

These anti-noise barriers consist of modular panels EC certified, made with excellent quality wood especially treated to withstand organic deterioration and mould due to prolonged weather exposure.

The panels have a solid wood frame to which is applied a back section made of match boarding wooden sheet with a minimum thickness of 20 mm; the front section is made of wooden rounded slats 25 mm thick which is esthetically pleasing and it serves the dual purpose of breaking down the sound waves and protect the material.

The wooden slats can be arranged in various configurations, in addition to the standard vertical one.

On the inside are placed layers of sound-absorbing material, and, in some cases, sound insulating as well, aptly spaced to achieve the desired noise mitigation.



All these materials are non-reactive to chemicals, not affected by weather exposure, do not decay, are fire proof, and, in case of fire, they will not emit harmful toxics or gas; they are protected externally by a thin green or black UV resistant silicon mesh.

The supporting structure is made of HE or HEB steel beams, galvanized or galvanized and painted, furnished with plates, back-plates, stud bolts, etc.

Applications

Remediation of noise originated from:

- Motorway and railway traffic
- Industrial production sites
- Entertainment and recreation venues
- Ventilation and air conditioning systems

Technical Data

Dimensions:

Length: mm. 2950 (nominally mm. 3000)
Height: mm. 1000/1500/2000 stacked
Thickness: mm. 120-150

Heads available for fitting in beams HEA/B 120, 140, 160, 180 fitted with EPDM soundproofing gaskets.

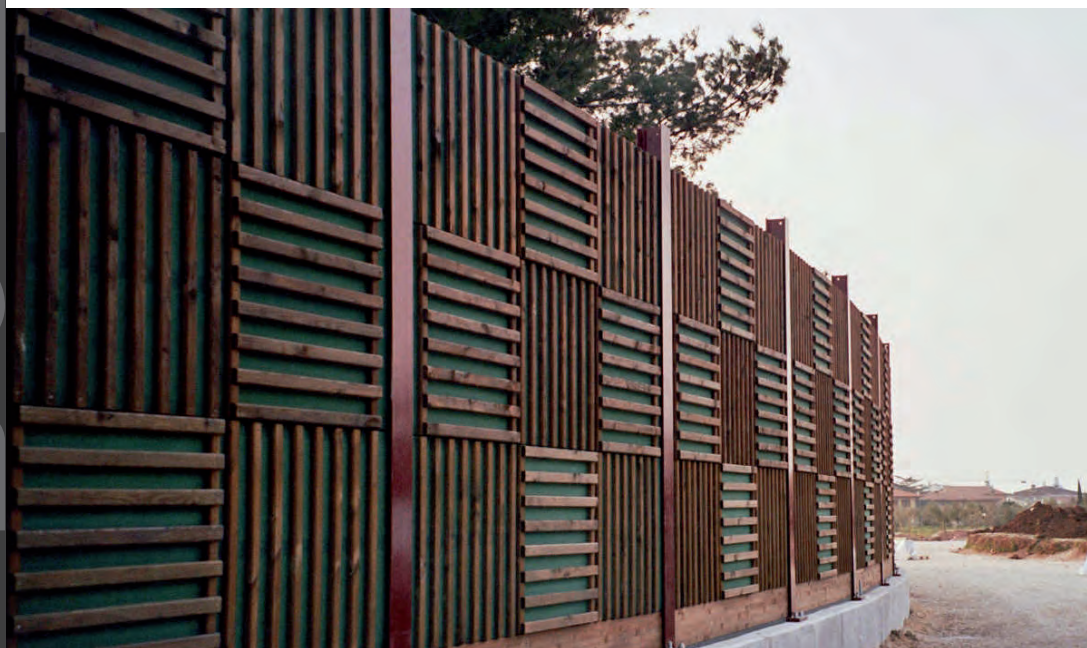

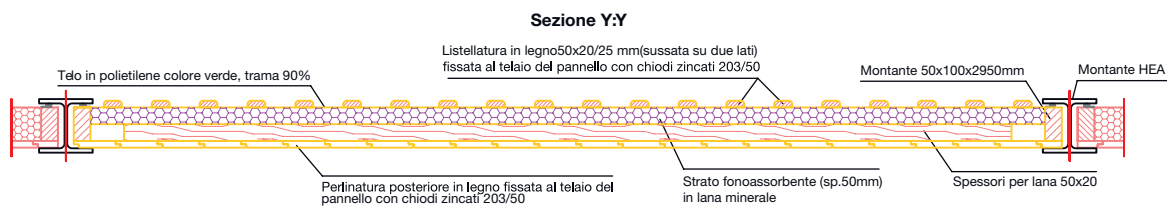
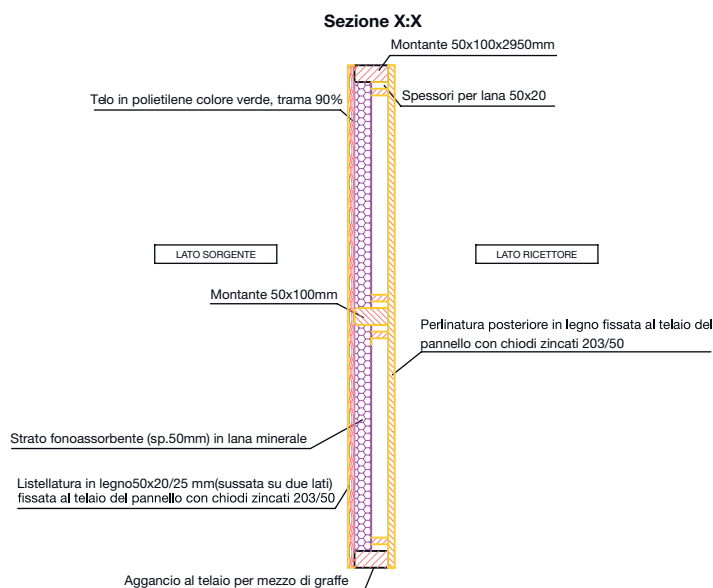
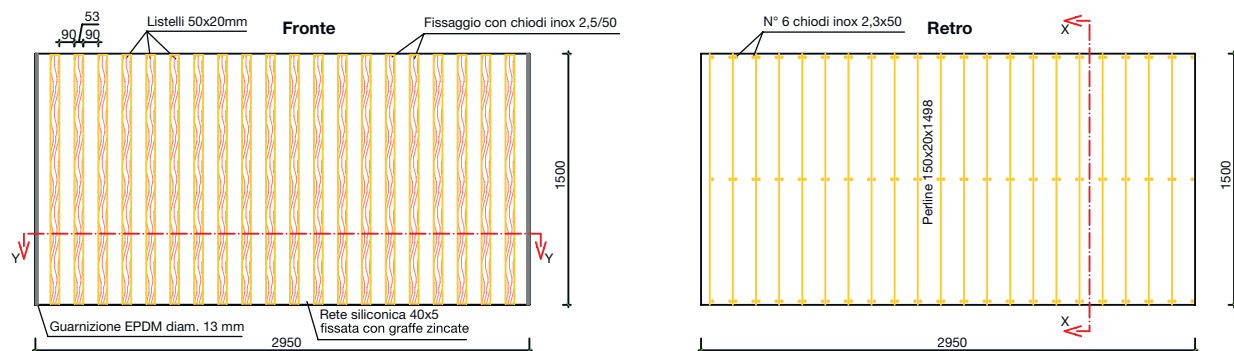

Acoustic Properties

The Series **Alfa** noise barriers are certified by accredited institutions and their acoustic properties will remain unaltered over time.

Certification for panels Series **alfa BS**:

- UNI EN 1793-1:97 classification table A.1
Acoustic absorption $DL\alpha = 12$ dB **cat. A4**
- EN 1793-2:97 classification table A.1
Soundproofing $DLr = 29$ dB **cat. B3**
- Classification ISO 140/95-3 and ISO 717/96-1
 $Rw = 34$ dB

Certification for panels Series **alfa 2M:**

- UNI EN 1793-1:97 classification table A.1
Acoustic absorption $DL\alpha = 14$ dB **cat. A4**
- EN 1793-2:97 classification table A.1
Soundproofing $DLr = 25$ dB **cat. B3**
- Classification ISO 140/95-3 and ISO 717/96-1
 $Rw = 31$ dB

Certification for panels Series **alfa iboce:**

- UNI EN 1793-2:97 classification table A.1
Acoustic absorption $DLr = 29$ dB **cat. B3**
- Classification ISO 140/95-3 and ISO 717/96-1
 $Rw = 32$ dB

More Certifications

The barriers Series **Alfa**, in addition to the acoustic certifications, meet the following requirements:

- Falling stones impact resistance compliant with EN 1794-1:98 annex C
- Wind resistance compliant with EN 1794-1:98 annex A with impact load of 250 Kg/sq.m
- Brush fire resistance compliant with EN 1794-2:98.A

Benefits

- Fits pleasantly in various settings
- Maintains acoustic quality and looks good over time
- Minimum maintenance
- Renewable and recyclable material originated from managed growth forests
- Easy installation on plinths, curbs, and existing short walls

Accessories

These accessories are available for the series **Alfa** barriers:

- Soundproofed PMMA inserts transparent, white or colored with solid wood frame treated for exteriors
- Upper flashing in wood or pre-painted steel
- Doors or gates for pedestrian or vehicle traffic
- Upper cylindrical attenuator
- Photovoltaic panels with optional automatic on-switch



Alfakel s.r.l.

Via G. Galilei 39/D
42027 Montecchio Emilia (RE)

Tel. 0522 86.35.23

Fax 0522 86.60.08

E-mail: info@alfakel.it

www.alfakel.it

The descriptions of Alfakel's products are merely indicative. Alfakel retains the rights to apply further modifications.

